

ATLAS  
of  
GREEN CO.  
WISCONSIN  
HARRISON & WARNER.

**ATLAS**  
OF  
**GREEN COUNTY**  
**WISCONSIN.**

*DRAWN FROM ACTUAL SURVEYS  
AND THE COUNTY RECORDS*

*To which is added*

**A RAIL ROAD & SECTIONAL MAP**

of the State of

**WISCONSIN.**

*Published by*

**HARRISON & WARNER**

**MADISON, WIS.**

Eng<sup>d</sup> by Worley & Bracher,  
31 South 6<sup>th</sup> St. Phil<sup>a</sup>

**1873.**

Printed by H. J. Toudy & Co.,  
525 Chestnut St. Philad<sup>a</sup>

*Oldach & Mergenthaler, Bookbinders,  
S. E. Cor. 7<sup>th</sup> & Cherry Sts. Philad<sup>a</sup>*

## TABLE OF CONTENTS.

	PAGE		PAGE
Title . . . . .	1	Juda . . . . .	47
Contents . . . . .	3	Martin . . . . .	47
Table of Distances . . . . .	4	Monroe . . . . .	17
Outline Plan of Green County . . . . .	5	Monroe Village . . . . .	21, 22
Adams . . . . .	33	Monticello . . . . .	41
Albany . . . . .	39	Mt. Pleasant . . . . .	37
Albany Village . . . . .	41	New Glarus . . . . .	45
Attica . . . . .	47	New Glarus Village . . . . .	47
Brodhead . . . . .	31	Postville . . . . .	47
Brooklyn . . . . .	51	Shucyville . . . . .	47
Brooklyn Village . . . . .	47	Spring Grove . . . . .	13
Cadiz . . . . .	7	Spring Grove Village . . . . .	47
Cadiz Village . . . . .	47	Sylvester . . . . .	27
Clarno . . . . .	9	Washington . . . . .	35
Dayton . . . . .	47	York . . . . .	43
Decatur . . . . .	29	Territorial History of Wisconsin . . . . .	53
Exeter . . . . .	49	Population of Wisconsin, Census of 1870 . . . . .	54
Jefferson . . . . .	11	Railroad and Sectional Map of the State of Wisconsin . . . . .	56, 57, 58, 59
Jordan . . . . .	15		

Outline Plan of

CHERRY CO. MS.

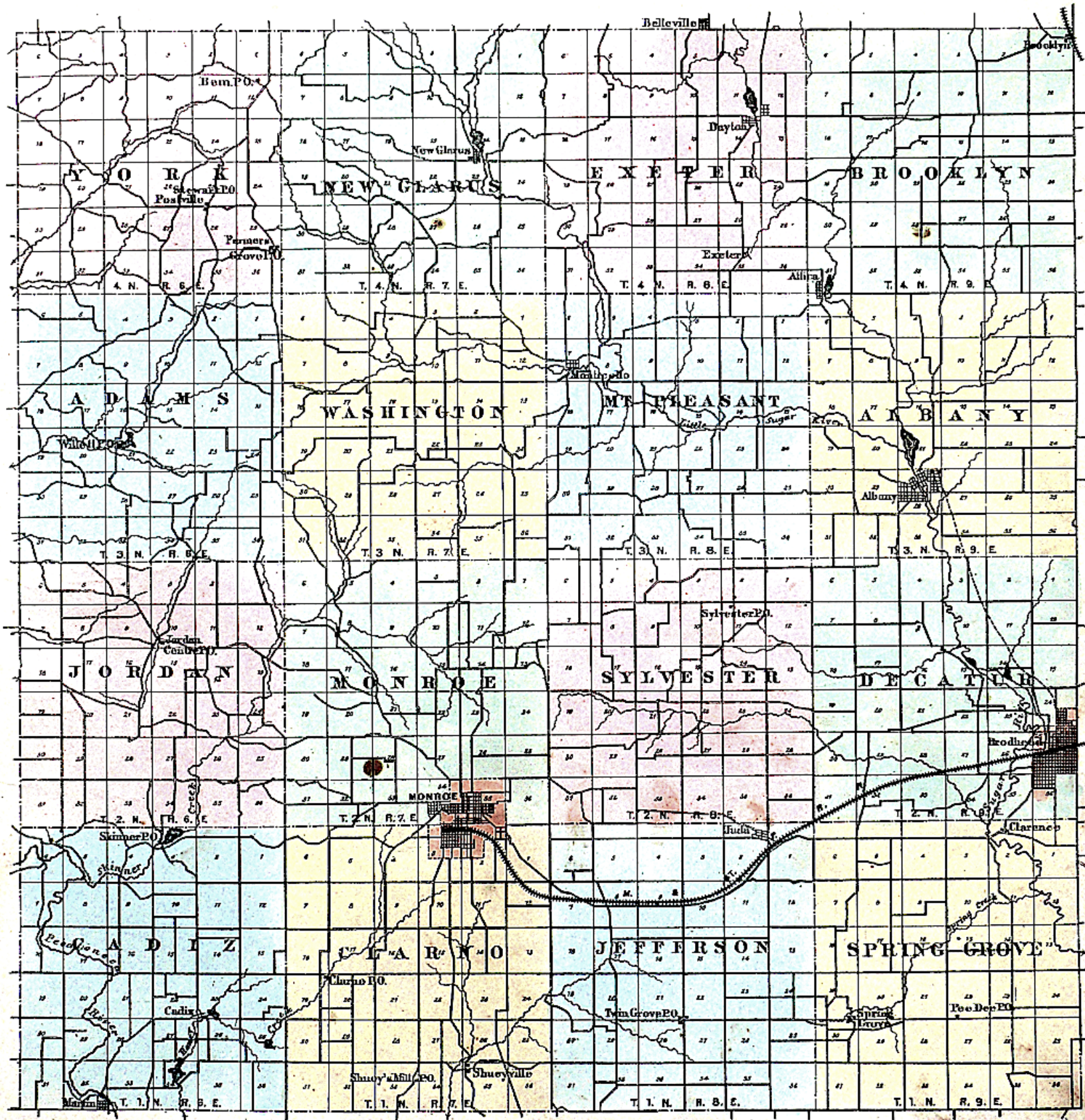





# CADIZ

Township 1 North, Range 6 East  
of 4th Principal Meridian

Scale 2 Inches to 1 Mile

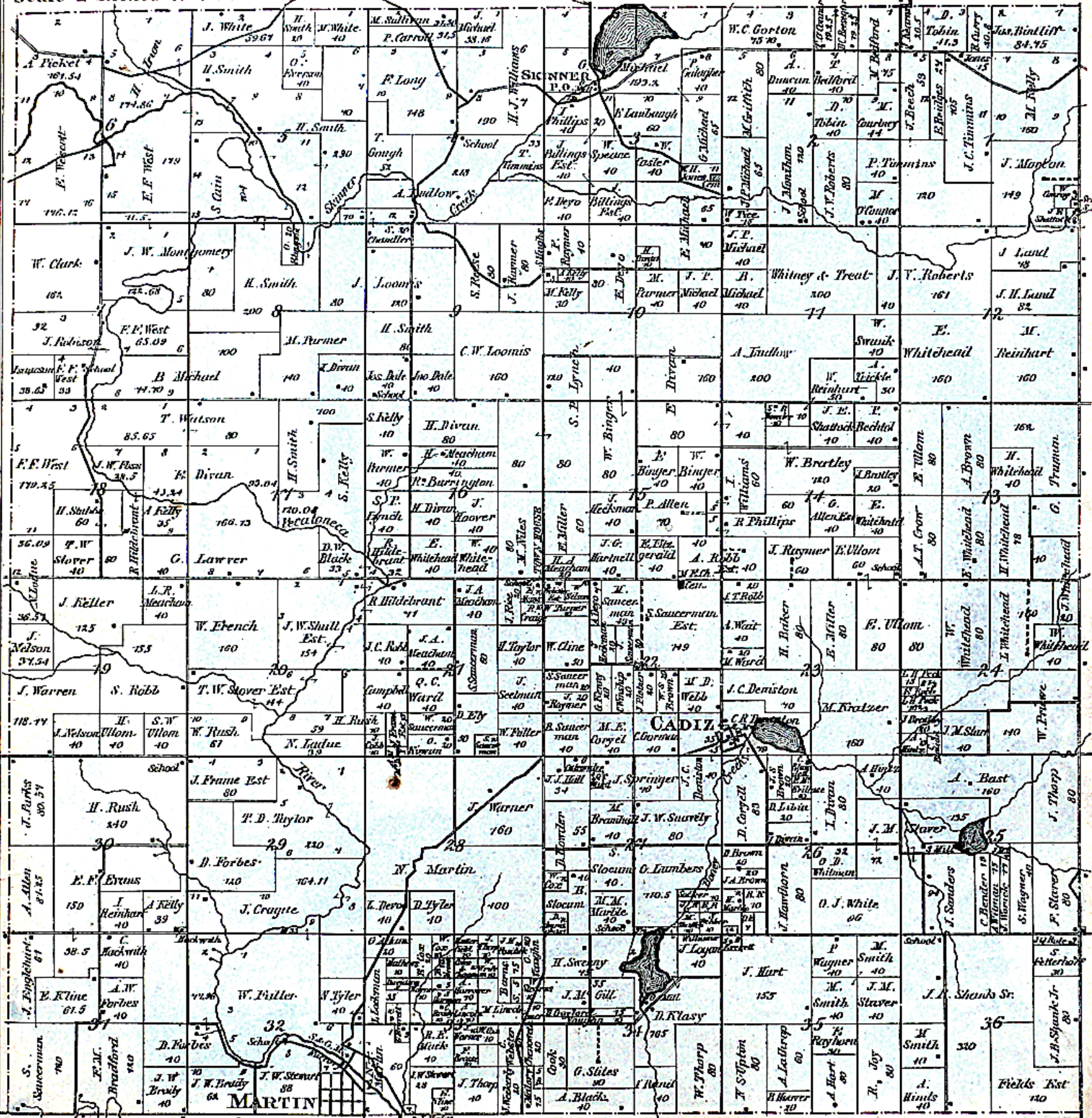











# JORDAN

Township 2 North, Range 6 East  
of 4<sup>th</sup> Principal Meridian  
Scale 2 Inches to 1 Mile

- I. Taylor, Farmer and Stock Grower. Sec. 7.
- H. Bawin, " " " " " 8.
- H. Taylor, " " " " " 21.
- L. P. Osgood, " " " " " 14.
- A. P. Wells, " " " " " 25.
- Otis F. Wells, " " " " " 22.
- H. Rust, " " " " " and Miller. 35.

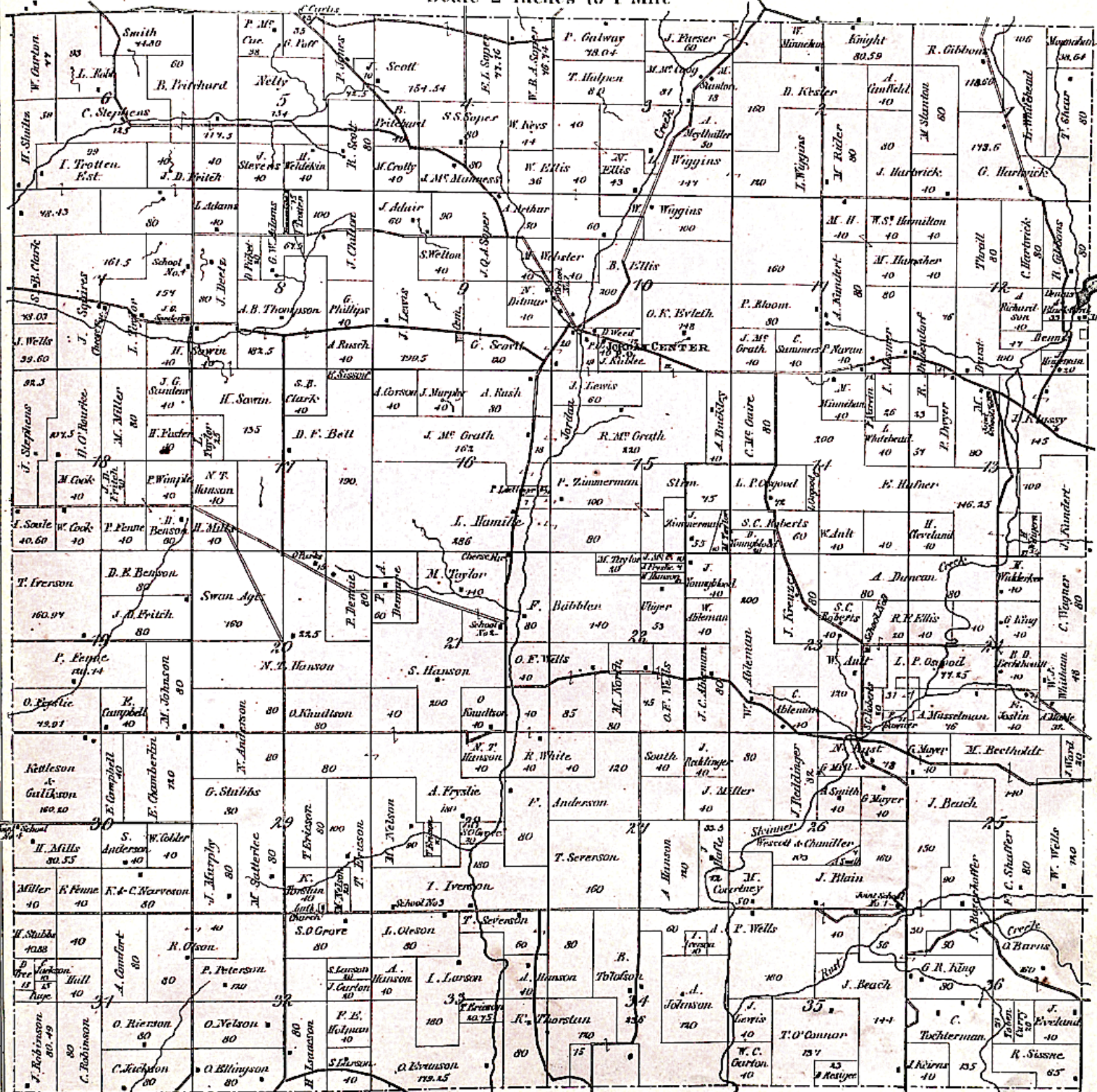







GREEN COUNTY ATLAS  
**SPRING GROVE**

Scale 2 Inches to 1 Mile

Township 1 North, Range 9 East  
of 4th Principal Meridian

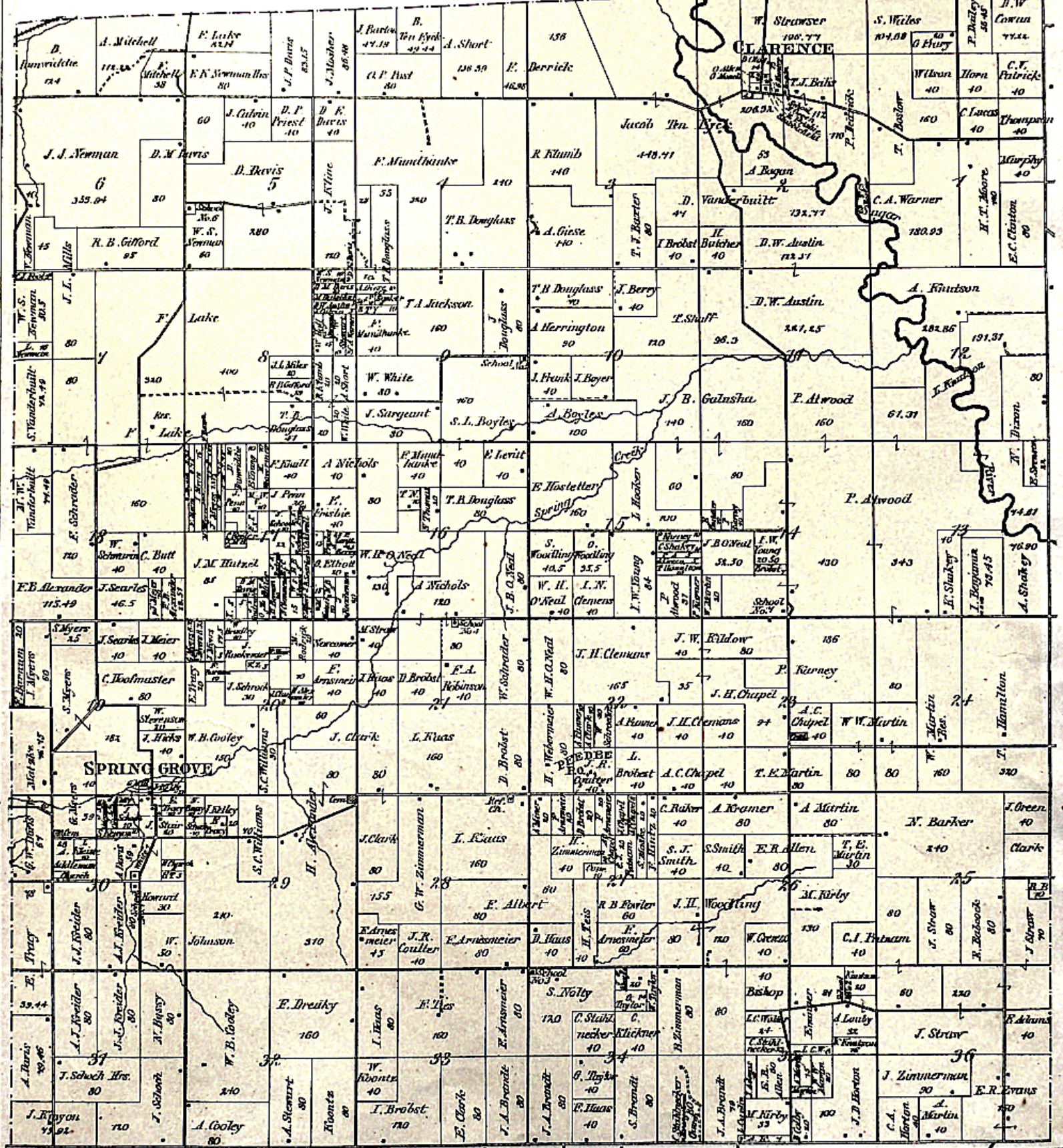





# YORK

Township 4 North, Range 6 East  
of 4th Principal Meridian  
Scale 2 Inches to 1 Mile

J. F. Wessott, Dealer in Dry Goods, Groceries, Hardware,  
Boots, Shoes, Hats, Caps, Agricultural Implements,  
Paints, Oils, Drugs, Patent Medicines, etc. etc.  
Farmer's Grove.

J. S. Gabriel, Farmer and Stock Grower. Sec. 27.  
Wm. M. Brooks, " " " " " 31.  
Joseph Miller, " " " " " 26.

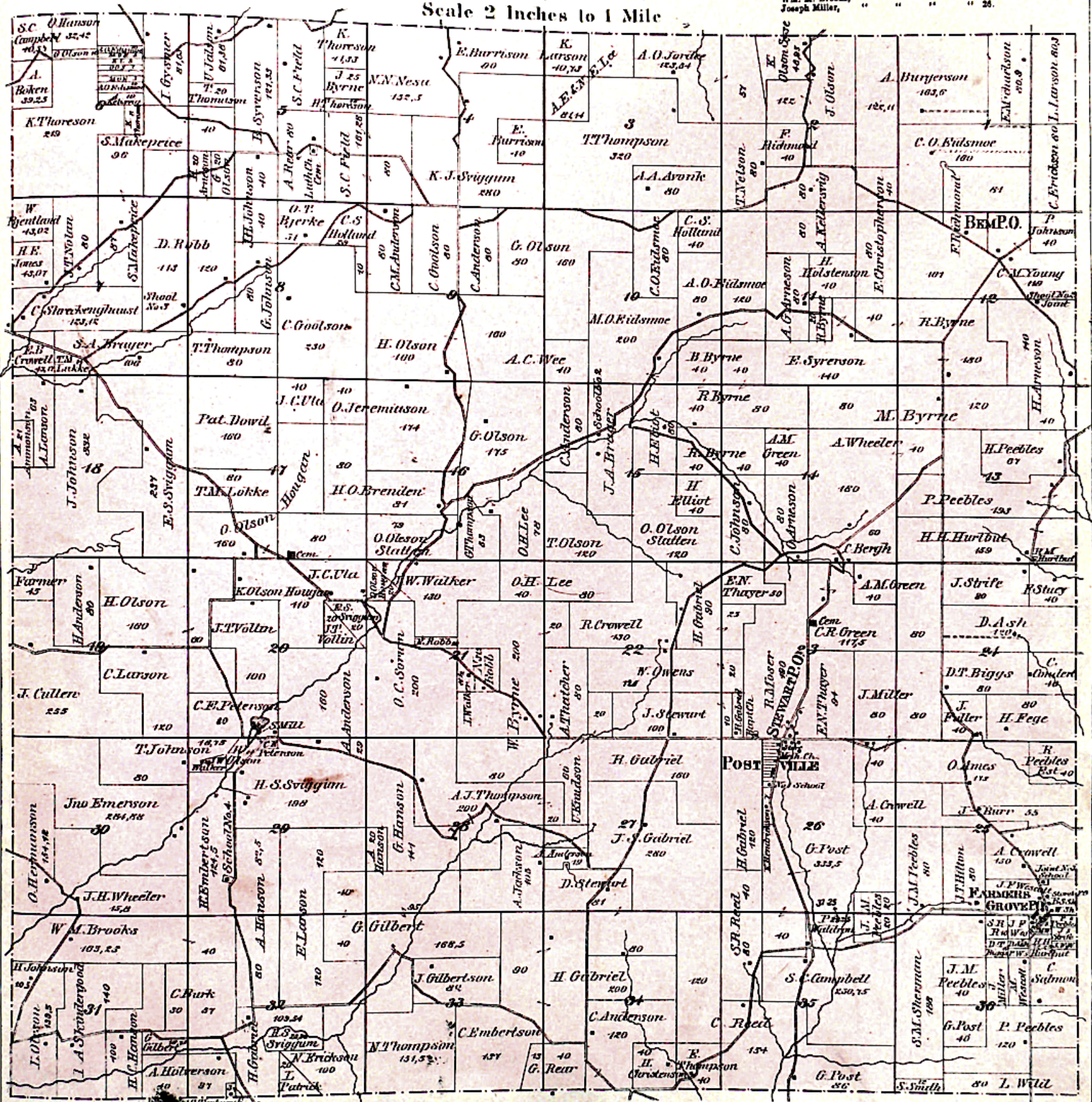



# BRODHEAD

- A. Brodhead
- B. Pierce's Add.
- C. Clinton's "
- D. Day & West's "
- E. Dixon's "

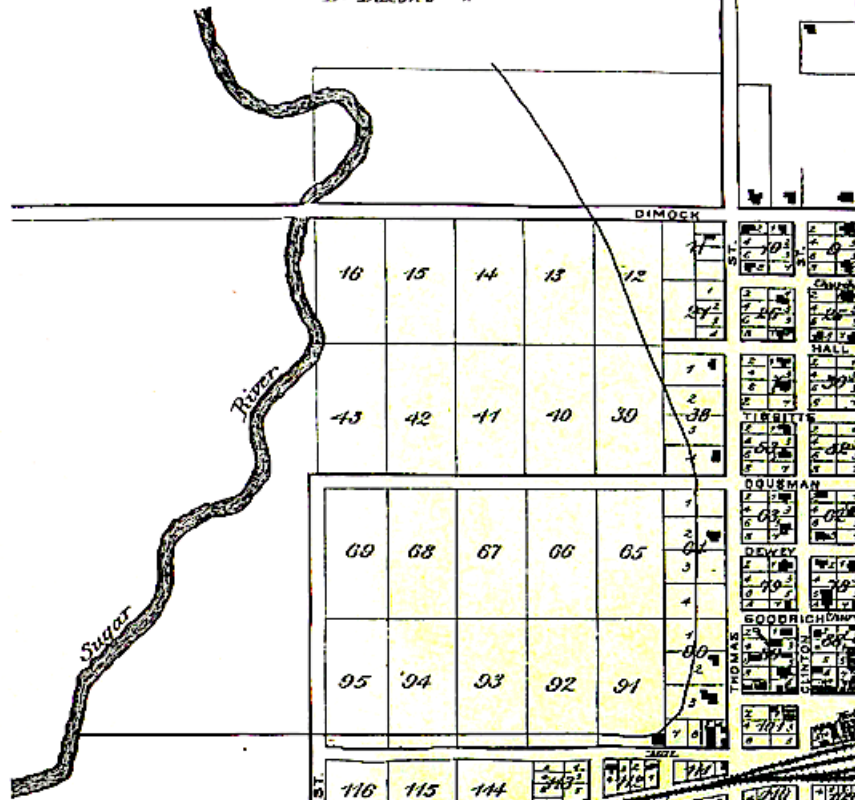

16	15	14	13	12	11
43	42	41	40	39	38
69	68	67	66	65	64
95	94	93	92	91	90
116	115	114	113	112	111
130	129	128	127	126	125
18	17	16	15	14	13
21	20	19	18	17	16
24	23	22	21	20	19
11	10	9	8	7	6
12	11	10	9	8	7
13	12	11	10	9	8
14	13	12	11	10	9
15	14	13	12	11	10
204	203	202	201	200	199

MCLENNAN	ST.	1	2	3	4	5	6	7	8	9	10	11	12	13	14	15	16	17	18	19	20	21	22	23	24	25	26	27	28	29	30	31	32	33	34	35	36	37	38	39	40	41	42	43	44	45	46	47	48	49	50	51	52	53	54	55	56	57	58	59	60	61	62	63	64	65	66	67	68	69	70	71	72	73	74	75	76	77	78	79	80	81	82	83	84	85	86	87	88	89	90	91	92	93	94	95	96	97	98	99	100
BARNET	ST.	1	2	3	4	5	6	7	8	9	10	11	12	13	14	15	16	17	18	19	20	21	22	23	24	25	26	27	28	29	30	31	32	33	34	35	36	37	38	39	40	41	42	43	44	45	46	47	48	49	50	51	52	53	54	55	56	57	58	59	60	61	62	63	64	65	66	67	68	69	70	71	72	73	74	75	76	77	78	79	80	81	82	83	84	85	86	87	88	89	90	91	92	93	94	95	96	97	98	99	100
GREEN	ST.	1	2	3	4	5	6	7	8	9	10	11	12	13	14	15	16	17	18	19	20	21	22	23	24	25	26	27	28	29	30	31	32	33	34	35	36	37	38	39	40	41	42	43	44	45	46	47	48	49	50	51	52	53	54	55	56	57	58	59	60	61	62	63	64	65	66	67	68	69	70	71	72	73	74	75	76	77	78	79	80	81	82	83	84	85	86	87	88	89	90	91	92	93	94	95	96	97	98	99	100
MCLENNAN	ST.	1	2	3	4	5	6	7	8	9	10	11	12	13	14	15	16	17	18	19	20	21	22	23	24	25	26	27	28	29	30	31	32	33	34	35	36	37	38	39	40	41	42	43	44	45	46	47	48	49	50	51	52	53	54	55	56	57	58	59	60	61	62	63	64	65	66	67	68	69	70	71	72	73	74	75	76	77	78	79	80	81	82	83	84	85	86	87	88	89	90	91	92	93	94	95	96	97	98	99	100
LAIRD	ST.	1	2	3	4	5	6	7	8	9	10	11	12	13	14	15	16	17	18	19	20	21	22	23	24	25	26	27	28	29	30	31	32	33	34	35	36	37	38	39	40	41	42	43	44	45	46	47	48	49	50	51	52	53	54	55	56	57	58	59	60	61	62	63	64	65	66	67	68	69	70	71	72	73	74	75	76	77	78	79	80	81	82	83	84	85	86	87	88	89	90	91	92	93	94	95	96	97	98	99	100
ST. JOHN	ST.	1	2	3	4	5	6	7	8	9	10	11	12	13	14	15	16	17	18	19	20	21	22	23	24	25	26	27	28	29	30	31	32	33	34	35	36	37	38	39	40	41	42	43	44	45	46	47	48	49	50	51	52	53	54	55	56	57	58	59	60	61	62	63	64	65	66	67	68	69	70	71	72	73	74	75	76	77	78	79	80	81	82	83	84	85	86	87	88	89	90	91	92	93	94	95	96	97	98	99	100
PIERCE	ST.	1	2	3	4	5	6	7	8	9	10	11	12	13	14	15	16	17	18	19	20	21	22	23	24	25	26	27	28	29	30	31	32	33	34	35	36	37	38	39	40	41	42	43	44	45	46	47	48	49	50	51	52	53	54	55	56	57	58	59	60	61	62	63	64	65	66	67	68	69	70	71	72	73	74	75	76	77	78	79	80	81	82	83	84	85	86	87	88	89	90	91	92	93	94	95	96	97	98	99	100
CHAMPLAIN	ST.	1	2	3	4	5	6	7	8	9	10	11	12	13	14	15	16	17	18	19	20	21	22	23	24	25	26	27	28	29	30	31	32	33	34	35	36	37	38	39	40	41	42	43	44	45	46	47	48	49	50	51	52	53	54	55	56	57	58	59	60	61	62	63	64	65	66	67	68	69	70	71	72	73	74	75	76	77	78	79	80	81	82	83	84	85	86	87	88	89	90	91	92	93	94	95	96	97	98	99	100
CHAMPLAIN	ST.	1	2	3	4	5	6	7	8	9	10	11	12	13	14	15	16	17	18	19	20	21	22	23	24	25	26	27	28	29	30	31	32	33	34	35	36	37	38	39	40	41	42	43	44	45	46	47	48	49	50	51	52	53	54	55	56	57	58	59	60	61	62	63	64	65	66	67	68	69	70	71	72	73	74	75	76	77	78	79	80	81	82	83	84	85	86	87	88	89	90	91	92	93	94	95	96	97	98	99	100
CHAMPLAIN	ST.	1	2	3	4	5	6	7	8	9	10	11	12	13	14	15	16	17	18	19	20	21	22	23	24	25	26	27	28	29	30	31	32	33	34	35	36	37	38	39	40	41	42	43	44	45	46	47	48	49	50	51	52	53	54	55	56	57	58	59	60	61	62	63	64	65	66	67	68	69	70	71	72	73	74	75	76	77	78	79	80	81	82	83	84	85	86	87	88	89	90	91	92	93	94	95	96	97	98	99	100
CHAMPLAIN	ST.	1	2	3	4	5	6	7	8	9	10	11	12	13	14	15	16	17	18	19	20	21	22	23	24	25	26	27	28	29	30	31	32	33	34	35	36	37	38	39	40	41	42	43	44	45	46	47	48	49	50	51	52	53	54	55	56	57	58	59	60	61	62	63	64	65	66	67	68	69	70	71	72	73	74	75	76	77	78	79	80	81	82	83	84	85	86	87	88	89	90	91	92	93	94	95	96	97	98	99	100
CHAMPLAIN	ST.	1	2	3	4	5	6	7	8	9	10	11	12	13	14	15	16	17	18	19	20	21	22	23	24	25	26	27	28	29	30	31	32	33	34	35	36	37	38	39	40	41	42	43	44	45	46	47	48	49	50	51	52	53	54	55	56	57	58	59	60	61	62	63	64	65	66	67	68	69	70	71	72	73	74	75	76	77	78	79	80	81	82	83	84	85	86	87	88	89	90	91	92	93	94	95	96	97	98	99	100
CHAMPLAIN	ST.	1	2	3	4	5	6	7	8	9	10	11	12	13	14	15	16	17	18	19	20	21	22	23	24	25	26	27	28	29	30	31	32	33	34	35	36	37	38	39	40	41	42	43	44	45	46	47	48	49	50	51	52	53	54	55	56	57	58	59	60	61	62	63	64	65	66	67	68	69	70	71	72	73	74	75	76	77	78	79	80	81	82	83	84	85	86	87	88	89	90	91	92	93	94	95	96	97	98	99	100
CHAMPLAIN	ST.	1	2	3	4	5	6	7	8	9	10	11	12	13	14	15	16	17	18	19	20	21	22	23	24	25	26	27	28	29	30	31	32	33	34	35	36	37	38	39	40	41	42	43	44	45	46	47	48	49	50	51	52	53	54	55	56	57	58	59	60	61	62	63	64	65	66	67	68	69	70	71	72	73	74																										

# ALBANY

*S. F. Nichols*

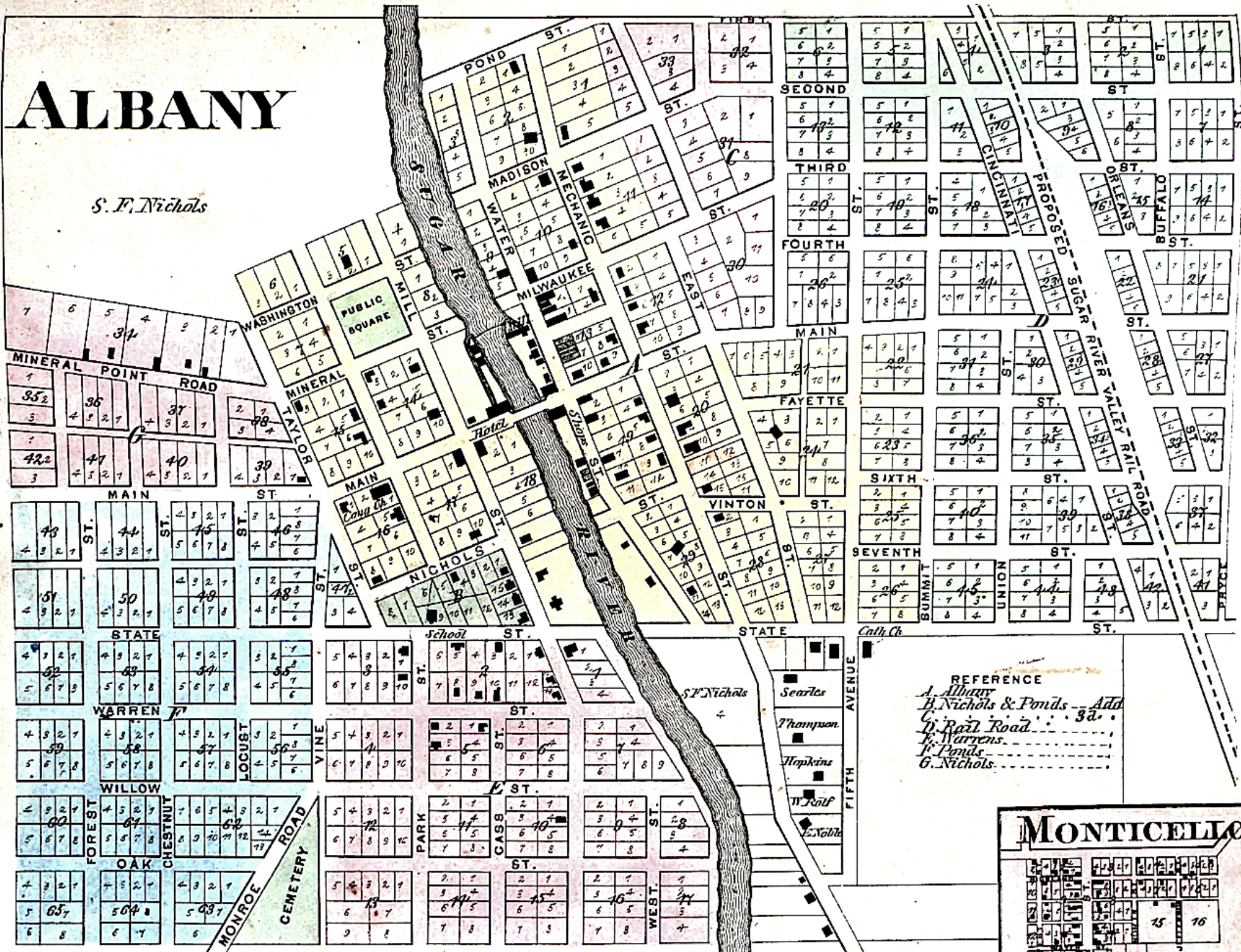

REFERENCE  
*A. Albany*  
*B. Nichols & Ponds - Add 32*  
*C. Rail Road*  
*D. Warrens*  
*E. Ponds*  
*F. Nichols*

## MONTICELLO

DIRECTORY  
*Orin Bacon, Prop'r Monticello Mills*  
*G. A. Herrick, Shoemaker & Painter*  
*H. C. Alden, Florist*  
*H. Sears, Prop'r of Monticello Woolen Mills. Sec. 8.*

### Albany Business Directory.

E. F. Warren, Merchant and Miller.  
 L. H. Warren, Produce Dealer.  
 H. Vanwart, Prop'r Billiard Hall.  
 J. B. Perry, Justice of the Peace and Attorney.  
 H. S. Beale, Insurance Agent.  
 Joseph Thompson, Traveling Agent.

W. H. Hudson, Dealer in Stock.  
 G. W. Roberts, Physician.  
 G. L. Holiday, Machinist.  
 R. D. Reed, Prop'r American House.  
 E. H. Winston, Physician and Surgeon.  
 S. A. Pond, Broker.  
 Samuel Mitchell, Farmer, Stock Raiser, and Manufacturer of Cheese, Sec. 28 Albany Town.

Asahel Hill, Farmer and Mechanic, Sec. 33.  
 D. Smiley, Farmer and Stock Raiser, Sec. 33.  
 G. W. Bagley, " " " " Sec. 32.  
 Chas. Hoegan, " " " " Sec. 24.  
 Ole Gilbertson, " " " " Sec. 8.  
 J. F. Lacy, Farmer and Stock Dealer, Sec. 31.  
 C. Robinson, " " " " Sec. 24.  
 Beth V. Peabie, " " " " Sec. 24.  
 A. T. Whitcomb, Farmer and Manuf'r of Cheese, Sec. 33.